



TOP 100 GIANTS

spotools



**BY ALL INDICATIONS,
2017 WAS A STELLAR YEAR.**

Total design fees hit \$4.1 billion, a 5 percent gain from the previous survey and a 70 percent gain over the past decade.

This matched the Giants' own forecast, and they expect \$4.4 billion next time.





1 GENSLER

With more than 3,500 active clients, Gensler works across the global economy. Their clients are remarkably diverse: large and small, private and public, for-profit and nonprofit. They help them grow, sustain and transform: whatever it takes to embrace their future.

Gensler is widely recognized as the world's leading collaborative design firm, not just the largest. The ability to work together as an integrated team is part of our DNA, and they've embraced it at every level, from their Co-CEOs to their studios and project teams.

The focus of Gensler leadership is on serving their clients effectively wherever they need their services.

+ INFO



INFORMATIONS

WEBSITE | www.gensler.com

BLOG | www.gensleron.com

CO-CEO | Diane Hoskins +1 202 721 5218
Andy Cohen +1 213 327 3610

OFFICES | 44 (Around the World)



2 PERKINS + WILL



INFORMATIONS

WEBSITE | www.perkinswill.com

NEWS | www.perkinswill.com/news/

CEO | Phil Harrison

OFFICES | 24 (Around the World)

Founded on the belief that design has the power to transform lives and enhance communities, the brand collaborates with clients all over the world to create healthy, sustainable places in which to live, learn, work, play, and heal.

More than 2,000 professionals across over 20 Perkins+Will offices include some of the brightest minds in architecture, interior design, branded environments, urban design, and landscape architecture.

Clients consistently turn to them for their leadership and expertise in areas like sustainability, resilience, health and wellness, and mobility.

+ INFO



3 AECOM

AECOM is a global network of experts working with clients, communities and colleagues to develop and implement innovative solutions to the world's most complex challenges.

Delivering clean water and energy. Building iconic skyscrapers. Planning new cities. Restoring damaged environments. Connecting people and economies with roads, bridges, tunnels and transit systems. Designing parks where children play. Helping governments maintain stability and security.

They connect expertise across services, markets, and geographies to deliver transformative outcomes.



INFORMATIONS

WEBSITE | www.aecom.com

NEWS | www.aecom.com/news/

CEO | Michael S. Burke

OFFICES | 7 Main Offices

+ INFO



4 HOK



INFORMATIONS

WEBSITE | www.hok.com

NEWS | www.hok.com/about/news/

CEO | Bill Hellmuth

OFFICES | 23 (Around the World)

HOK uses design to enrich people's lives and help organizations succeed. Our 1,700 people collaborate across a network of 23 offices on three continents.

HOK's mission is to deliver exceptional design ideas and solutions for our clients through the creative blending of human need, environmental stewardship, value creation, science and art.

Our design solutions result from a collaborative process that encourages multidisciplinary professional teams to research alternatives, share knowledge and imagine new ways to solve the challenges of the built environment.

+ INFO



5 JACOBS

At Jacobs, the focus on building long-term client relationships has helped them become one of the largest and most diverse providers of technical, professional and construction services, including all aspects of architecture, engineering and construction, operations and maintenance, as well as scientific and specialty consulting.

Their 54,000 employees in 230+ locations around the world serve a broad range of companies and organizations, including industrial, commercial, and government clients across multiple markets and geographies.



INFORMATIONS

WEBSITE | www.jacobs.com

NEWS | www.jacobs.com/news

CEO | Steve Demetriou

OFFICES | +230 (Around the World)

+ INFO



6 HBA



INFORMATIONS

WEBSITE | www.hba.com

NEWS | www.hba.com/news

CO-CEO | Ian Carr
René Gross Kærskov

OFFICES | 27 (Around the World)

HBA creates inspired, brand-strengthening design experiences that evoke a distinct sense of place, while delighting the world's most discriminating travelers. Around the globe, HBA consistently sets new standards for luxury, comfort and innovation in hospitality interior design.

HBA's international presence, depth of experience and detailed industry knowledge enables its designers to identify interior design trends at their source, make definitive predictions about new directions and innovations and influenced sign standards at a global level. HBA's ultimate objective is to add value, raise standards and enhance the brand of a projects owner and operator.

+ INFO



7 IA INTERIOR ARCHITECTS

IA is a global firm of architects, designers, strategists, and specialists.

They focus exclusively on environments through the lens of interior architecture — a radical idea in 1984, when IA was founded. They are highly connected agents of change, committed to creativity, innovation, growth & communities.

They're inspired to work alongside their clients to resolve complex issues and design highly energized environments where people thrive. Through their work they strive to share their passion with their clients.



INFORMATIONS

WEBSITE | www.interiorarchitects.com

BLOG | www.interiorarchitects.com/blog/

CO-CEO | David Bourke
Tom Powers

OFFICES | +21 (Around the World)

+ INFO



INFORMATIONS

WEBSITE | www.stantec.com

NEWS | www.ideas.stantec.com

CO-CEO | Gord Johnston

OFFICES | +400 (Around the World)

Communities are fundamental. Whether around the corner or across the globe, they provide a foundation, a sense of place and of belonging. That's why at Stantec, they always design with community in mind.

They care about the communities they serve—because they're also their communities too. This allows them to assess what's needed and connect their expertise, to appreciate nuances and envision what's never been considered, to bring together diverse perspectives so they can collaborate toward a shared success.

+ INFO



9 NELSON

The company operates to serve the needs of their clients from various offices throughout the United States from their first office in Philadelphia, PA to their most recent.

Fulfilling the needs of their clients is their most critical driving force, and they must provide those services in compliance with the requirements of the various agencies of state and local government that regulate the delivery of their various services and professional design disciplines.

NELSON is organized into several affiliated companies, owned by those licensed professionals who have the required registrations in the states where they provide professional services.

+ INFO



INFORMATIONS

WEBSITE | www.nelsononline.com

BLOG | www.blog.nelsononline.com

CO-CEO | John "Ozzie" Nelson Jr.
Jim Tippmann

OFFICES | 22 (Around the World)



10 HKS



INFORMATIONS

WEBSITE | www.hksinc.com

NEWS | www.ideas.stantec.com

CEO & PRESIDENT | Dan Noble

OFFICES | 24 (Around the World)

To those wanting to make an impact with design, HKS is the architect where focused people consistently deliver the extraordinary.

They are passionate, knowing that people live, work, play and inhabit the spaces and places they imagine and envision for their clients. They are responsive, understanding that they are in a service business and the vision is that of their clients – never of theirs alone.

They are global, creating exceptional spaces across the globe through their connected network of offices and people.

+ INFO

OUR DESIGN TOOLS WILL INSPIRE YOU THROUGH HIGH-END INTERIOR DESIGN

> GET YOUR BEST DESIGN TOOL <





11 LEO A DALY

LEO A DALY is an internationally-recognized, award-winning architecture, engineering, planning, interior design, and program management firm. They are consistently ranked among the top design firms in the world. Their diverse portfolio includes world-class projects in more than 91 countries, all 50 US states, and the District of Columbia.

Their firm rose to national prominence for pioneering the use of interdisciplinary project teams: a "whole project" approach that ensures maximum efficiency, coordination, and client satisfaction.

Their services are extended through Lockwood, Andrews & Newnam, Inc. (LAN), a LEO A DALY company.

+ INFO



INFORMATIONS

WEBSITE | www.leoadaly.com

NEWS | www.leoadaly.com/perspectives

CO-CEO | Leo A. Daly III

OFFICES | 30 (Around the World)



12 DLR GROUP



INFORMATIONS

WEBSITE | www.dlrgroup.com

NEWS | www.dlrgroup.com/insights

CEO | Griff Davenport

OFFICES | 30 (Around the World)

DLR Group believes integrated design is the practice of early collaboration in order to produce sustainable design excellence.

At the core of an integrated design firm are collaborative, interdisciplinary teams composed of all project lifecycle stakeholders.

These teams champion true collaboration, open information sharing, shared risk and reward, value-based decision making, and proficient use of technology to elevate design.

The outcome is sustainable design of a high performance building for a sustainable future.

+ INFO



13 M MOSER ASSOCIATES

At M Moser, they believe design can positively impact people's well-being and productivity through work and life. They are passionate about enabling transformative workplace culture.

Their team is constantly evolving into new areas of expertise, new applications of design and new regions around the world through the trust of their clients.

From workplace and master planning, to urbanism, culture, media, health, education and mixed-use projects, they leverage their global learnings, married with local know-how, to bring a truly international expertise to everything they do, regardless of its location.

+ INFO



INFORMATIONS

WEBSITE | www.mmoser.com

NEWS | www.mmoser.com/en/news

GMD | Dick Mak

OFFICES | 15 (Around the World)



14 CANNON DESIGN



INFORMATIONS

WEBSITE | www.cannondesign.com

NEWS | www.cannondesign.com/news-insights/blog/

CEO | Bradley A. Lukanic

OFFICES | 19 (Around the World)

CannonDesign is an integrated global design firm that unites a dynamic team of architects, engineers, industry experts and builders driven by a singular goal — to help solve their clients' and society's greatest challenges.

Their defining strength is their ability to harness creative intelligence — both ours and our clients — to develop solutions informed by a prism of perspectives, experiences, technologies and cultures.

They blend their diversity of expertise with empirical and ethnographic research, immersing ourselves in our clients' worlds to understand their needs in their context.

+ INFO



15 CALLISON RTKL

CallisonRTKL combines the legacy of two great design practices into an even stronger, more distinct voice that is characterized by the strength of our ideas, the spirit of their culture and the passion of their people to make the world a better place.

People are at the center of what we do. Focusing on their relationships, with clients and teams, helps them make the big seem small, more personal, and keeps them moving in the right direction.

Their process centers on creativity, cross-pollinating ideas and talents across offices to deliver quality at all levels and in all places.

+ INFO



INFORMATIONS

WEBSITE | www.callisonrtkl.com

NEWS | www.callisonrtkl.com/news

GMD | Tim Neal

OFFICES | 20 (Around the World)



16 SMITHGROUP JJR

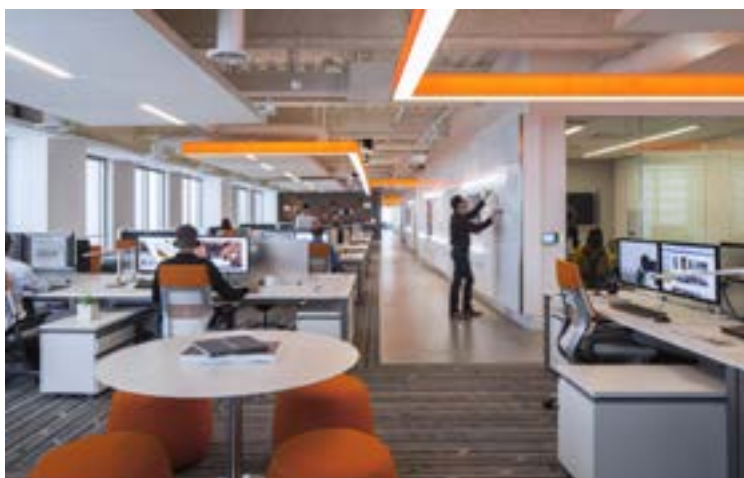

INFORMATIONS

WEBSITE | www.smithgroupjjr.com

NEWS | www.smithgroupjjr.com/design_topics

CEO | Carl Roehling

OFFICES | 12 (Around the World)

Their mission is to create a legacy of inspiring places that enhance the environment and enrich the human experience. That, in a nutshell, is the core purpose of SmithGroupJJR. They work together to create well-thought, well-crafted places that artfully balance beauty with function.

They do so while treating their clients, their coworkers and their communities with the utmost respect. That means we listen. It means we collaborate eagerly—with our clients, with our consultants and with one another.

We are bold innovators and passionate designers of extraordinary places.

+ INFO



17 PERKINS EASTMAN

Founded in 1881 in New York City, Perkins Eastman is a global architecture firm that has grown to include 1,000 employees working out of a combined 15 interdisciplinary offices around the world.

Their practice is founded on the idea that design can have a direct and positive impact on people's lives.

With eleven offices throughout North America and four located in East and Central Asia, MENA, and South America, their global presence enables them to bring all manner of expertise to the fore when it comes to thoughtful design.

They bring to you practical and holistic solutions for your projects.



INFORMATIONS

WEBSITE | www.perkinseastman.com

NEWS | www.perkinseastman.com/white_papers

FAIA | Bradford Perkins

OFFICES | 15 (Around the World)

+ INFO

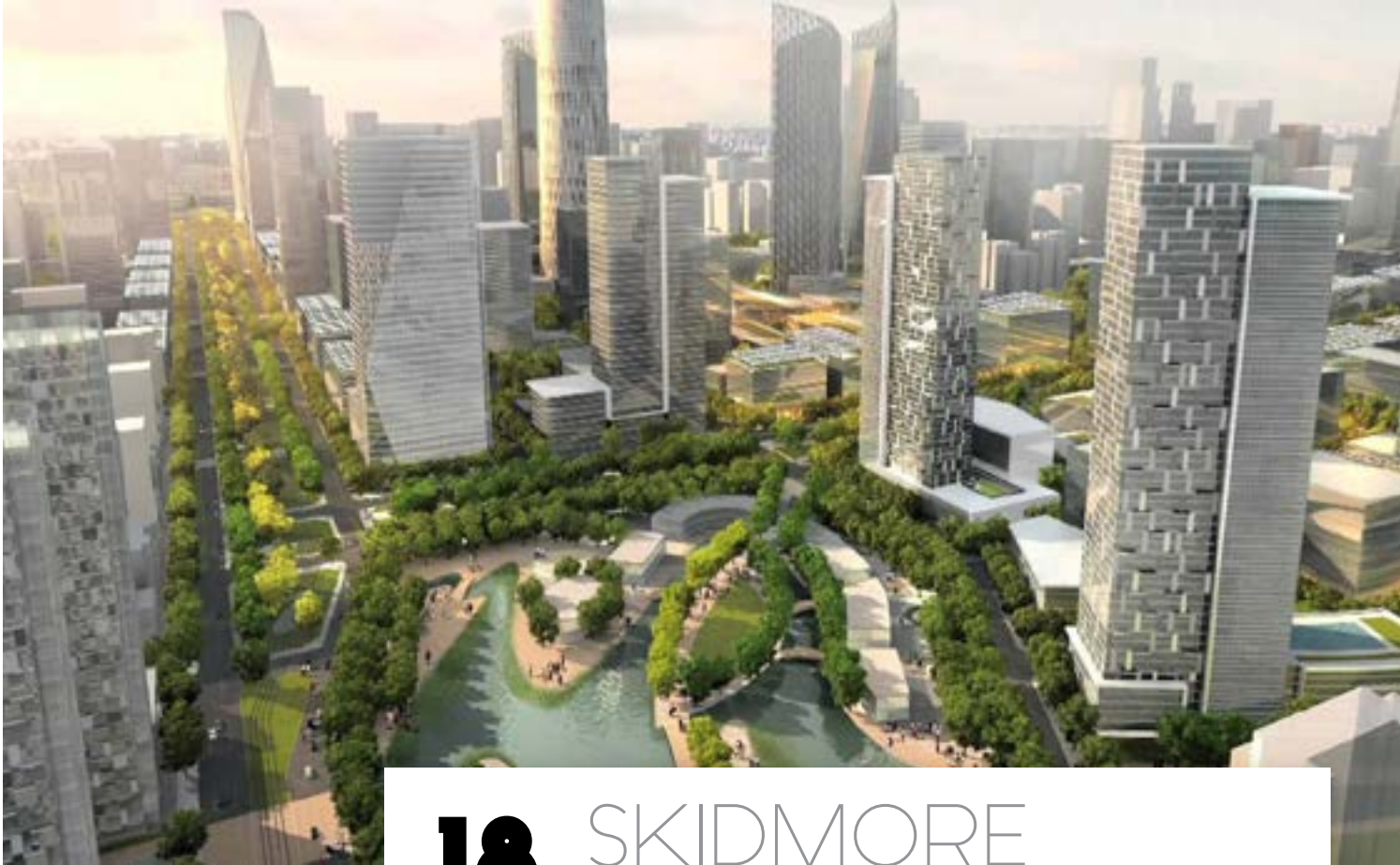

18

SKIDMORE OWINGS & MERRILL



INFORMATIONS

WEBSITE | www.som.com

NEWS | www.som.com/news

CEO | John H. Winkler

OFFICES | 10 (Around the World)

Skidmore, Owings & Merrill LLP (SOM) is one of the largest and most influential architecture, interior design, engineering, and urban planning firms in the world. Founded in 1936, they have completed more than 10,000 projects in over 50 countries. They are renowned for their iconic buildings and their commitment to design excellence, innovation, and sustainability.

Collaboration is a guiding force at SOM, as they believe that the best results stem from an ongoing dialogue with all stakeholders. With their clients as their partners, they approach each project as a unique challenge.

+ INFO



19 HGA

Their goal is to create a company and culture where everyone – employees and clients – can do the best work of their lives. They value empathy, are fueled by curiosity, and embrace the hard work that leads to innovation.

For the people who work, learn, heal, serve and gather in the spaces they shape, their goal is to exceed expectations – today, tomorrow and into the future.

They follow an innovative research-based approach to design. Their work is always built upon a foundation of unique insight into client needs. Upon this foundation of fresh understanding, they help clients create purposeful design with an enduring impact.

+ INFO



INFORMATIONS

WEBSITE | www.hga.com

NEWS | www.hga.com/news-and-events

CEO | Tim Carl

OFFICES | 8 (Around the World)



20 EYP



INFORMATIONS

WEBSITE | www.eypae.com

NEWS | www.eypae.com/expertise

CEO | Tom Birdsey

OFFICES | 15 (Around the World)

EYP Inc. is a global provider of high-performance building design, research, and consulting services. Our 500+ professionals work across 15 offices in the United States and Europe, and serve four sectors.

EYP has made a pledge to The 1+ to provide pro-bono design services to non-profit organizations. They also support organizations that benefit the markets they serve through corporate contributions, in-kind services, and volunteerism.

We provided pro-bono planning and design services to create a Nursing, Administration, and Social Work Building that will support Wildwood's summer camp program.

+ INFO



21 STEVE LEUNG DESIGNERS

In 1997, Mr. Steve Leung established Steve Leung Designers Ltd., subsequently opening branches in Shanghai, Beijing and Guangzhou. He works on a wide spectrum of design projects – hotels, restaurants, shops, office and show flats, etc.

In 2001, Steve branched out into furniture and product design, creating unique collections such as “i-chi”, “cube”, “ling-long”, “tenchi”, fur accessories for home and textile product.

As a dedicated contemporary advocate, Steve’s works reflect a strong and unique character, which skilfully blends minimalism with Asian culture and art.



INFORMATIONS

WEBSITE | www.steveleung.com

CONTACT | sld@steveleung.com

CEO | Steve Leung

OFFICES | ---

+ INFO



22 NBBJ



INFORMATIONS

WEBSITE | www.nbbj.com

BLOG | www.nbbj.com/blog

AIA | Dale Alberda

OFFICES | 11 (Around the World)

NBBJ is a different kind of design practice, one that helps their clients drive innovation by creating highly productive, sustainable spaces that free people to live, learn, work and play as they were meant to.

The world's leading organizations look to their experts to help them design environments that disrupt the status quo and effect real, meaningful change at all levels.

Their global network of "renaissance teams" includes more than 700 researchers, strategists, nurses, architects, anthropologists, planners and interior designers who generate ideas that have a profound and lasting impact.

+ INFO



23 WILSON ASSOCIATES

Wilson Associates is a collection of global studios and design-minded creatives providing interior architectural design, architecture, art consultancy, concept development, branding and food & beverage design.

Known for creating current, iconic, must-experience spaces, Wilson Associates has been innovating hospitality design for luxury and boutique brands for nearly 50 years.

Today, Wilson Associates offers a range of design services and specialty studios to meet clients' needs in the ever-evolving hospitality industry.



INFORMATIONS

WEBSITE | www.wilsonassociates.com

NEWS | www.muse.wilsonassociates.com

PRINCIPAL | Jim Rimelspach

OFFICES | 10 (Around the World)

+ INFO



24 TPG ARCHITECTURE



INFORMATIONS

WEBSITE | www.tpgarchitecture.com

BLOG | www.tpgarchitecture.com/news.cfm

AIA | James G. Phillips

OFFICES | 2 (New York)

TPG was founded in 1979. Headquartered in New York City with an office in Long Island and a London affiliate, the firm works locally, regionally, nationally and internationally.

While their core business focuses on Corporate Interiors and Retail Design, TPG has cultivated practice groups in Advanced Technology and Broadcast, Architecture, Healthcare, Education and Branding and Graphics.

Organized in sector-specific studios, TPG provides the strong personal and specialized service of a small firm as well as the breadth and depth of resources offered by a large organization.

+ INFO

spotools

FOLLOW OUR **SOCIAL MEDIA**





25 CORGAN

Corgan is a leading architecture and design firm with a human-centered approach, a deep technical experience and a reputation for great service to their clients, their people and their communities.

Consistently ranked as one of the top five architecture firms, they listen to their clients and transform their insights into structures and spaces that inspire, inform and innovate.

For nearly eight decades, Corgan has developed special expertise in aviation, commercial, critical facilities, education, healthcare and interior design projects.



INFORMATIONS

WEBSITE | www.corgan.com

NEWS | www.corgan.com/blog

CEO | Bob Morris

OFFICES | 13 (Around the World)

+ INFO



26 SPACE MATRIX

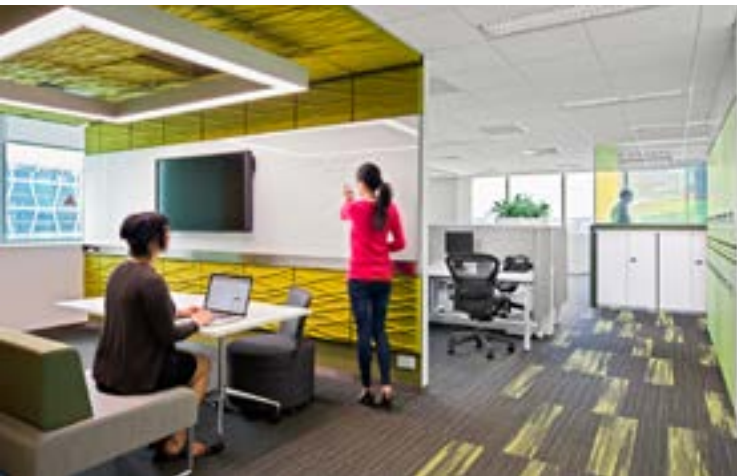

INFORMATIONS

WEBSITE | www.spacematrix.com

BLOG | www.spacematrix.com/news

CEO | Arsh Chaudhry

OFFICES | 13 (Around the World)

Founded in 2001, by Shagufta Anurag, their design practice has evolved into a dynamic, agile, 21st century digital enterprise; a design consultancy that specializes in workplace design.

They have developed a unique client focus that creates and delivers profitable, sustainable and future-ready workplace solutions.

Their continuing mission aims to continue revolutionizing the delivery of design and build services in both Asia and globally.

With a commitment for design excellence, Space Matrix consistently ranks in Interior Design Magazine's Top 100 Design Giants.

+ INFO



27 WARE MALCOMB

They attract people who are committed to continual learning, growing and improving. Their companywide mentoring program provides ongoing coaching and guidance to help develop their people.

Their growing team, comprised of awesome design and business professionals, is dedicated to providing great design and client service throughout all of their offices.

They are leaders in the design of buildings and spaces for the commercial and corporate real estate industries. Ware Malcomb has been recognized 4 consecutive years for their innovative and forward-thinking design concepts.

+ INFO



INFORMATIONS

WEBSITE | www.waremalcomb.com

NEWS | www.waremalcomb.com/news

CEO | Lawrence R. Armstrong

OFFICES | 22 (Around the World)



28 HDR



INFORMATIONS

WEBSITE | www.hdrinc.com

BLOG | www.hdrinc.com/news-and-events

CEO | Eric L. Keen

OFFICES | 225 (Around the World)

They believe that the way they work can add meaning and value to the world. That ideas inspire positive change. That coloring outside the lines can illuminate fresh perspectives.

They specialize in engineering, architecture, environmental and construction services. While they are most well-known for adding beauty and structure to communities through high-performance buildings and smart infrastructure, they provide much more than that.

Their employees, working in 225 locations around the world, push open the doors to what's possible each and every day.

+ INFO



29

ROCKWELL GROUP

Based in downtown New York with a satellite office in Madrid, they specialize in a wide array of work from luxury hospitality, cultural, and healthcare projects, to educational, product, and set design.

A combination of interactive technology, handmade objects, custom fixtures and furniture create environments that seamlessly integrate technology, craftsmanship and design.

Crafting a unique and individual narrative concept for each project is fundamental to Rockwell Group's successful design approach. From the big picture to the smallest detail, the story informs and drives the design.

+ INFO

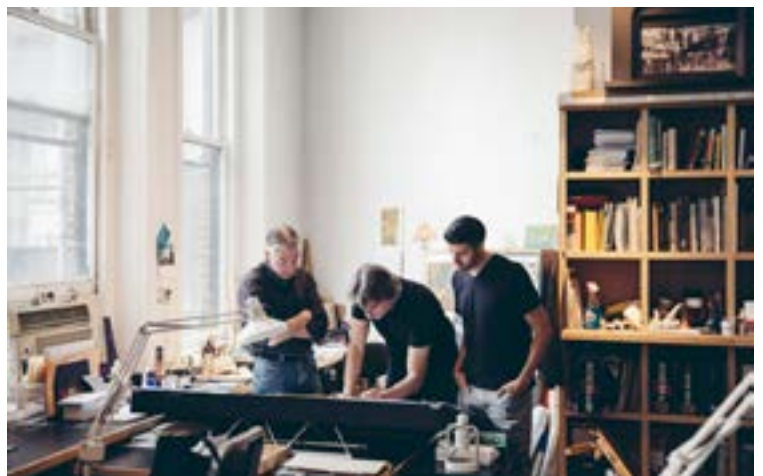

INFORMATIONS

WEBSITE | www.rockwellgroup.com

BLOG | www.rockwellgroup.com/blogs

PRESIDENT | David Rockwell

OFFICES | 2 (NY & Madrid)



30 PAGE



INFORMATIONS

WEBSITE | www.pagethink.com

BLOG | www.pagethink.com/v/blog/Blog/3h/

LEED AP | Robert E. Burke

OFFICES | 7 (Around the World)

They are a firm with a proud heritage that has benefited through the years from entrepreneurial skills and proven success in cultivating new generations of leadership.

At Page, their vision is to become influential champions for design that makes lives better.

Like their brand promise, that's pretty simple — pretty clear — as any good vision should be. They aspire to make an impact that extends beyond the work itself. To influence how design merit is perceived and defined.

And, ultimately, to help shift the global focus of design toward making a difference for the better in the way people live.

+ INFO



31 J&A

Jiang & Associates Design Co., Ltd (J&A) is a comprehensiveness design firm which involved in architecture, interior and MEP design field.

J&A has been specialized in designing city complexes for more than 10 years and accomplished many influential projects such as MIXC Xi'an, Dreamport Shanghai and Mandarin Oriental Shanghai.

With over 300 international background designers, J&A is reputed as the largest interior design company with branch offices located in Hong Kong, Shenzhen, Shanghai, Beijing, Dalian, Shenyang, Wuhan etc.



INFORMATIONS

WEBSITE | www.jaid.cn

NEWS | www.jaid.cn/news.aspx

PRESIDENT | Jiang Feng

OFFICES | 6 (Around the World)

+ INFO



32 TED MOUDIS ASSOCIATES



INFORMATION

WEBSITE | www.tedmoudis.com

BLOG | www.tedmoudis.com/news

AIA | Ted Moudis

OFFICES | 3 (Around the World)

Ted Moudis Associates designs workplaces that provide sustainable environments and flexible workplace solutions built for longevity, productivity, and enjoyment. We believe that a built space should not only reflect but also enhance an organization's culture and values.

They believe in the power of space. Your workplace is a key driver for your organization's success and continued growth. Their architecture and interior design experts partner with you to design the perfect solution that provides maximum productivity, flexibility, and innovation for your unique business.

+ INFO



33 ZGF

ZGF's diverse design portfolio includes new construction, renovations and additions at every scale, across the nation and around the world.

The outcome of every project is specific and unique, reflecting a deep understanding of the client's mission and aspirations, and responding to the site's environmental, physical and cultural context.

Working closely with their clients, ZGF develops interior environments that respond to each organization's brand, culture and functional needs. From workplace to children's hospitals, they create flexible, healthy and inspiring spaces that increase performance, occupant satisfaction and comfort.

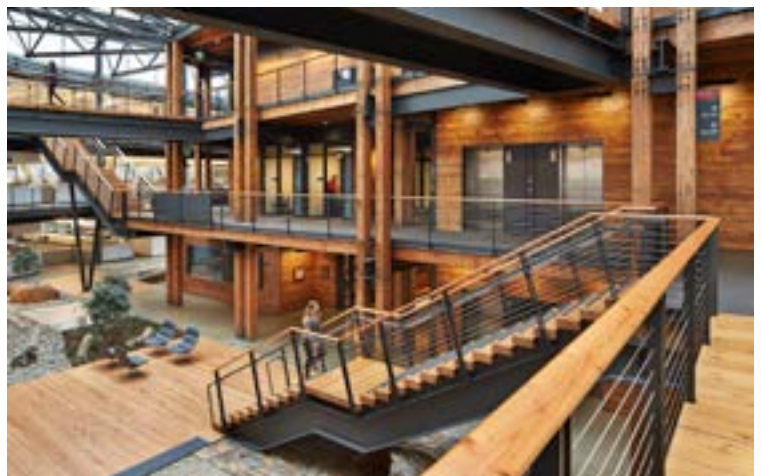

INFORMATIONS

WEBSITE | www.zgf.com

NEWS | www.zgf.com/news

AIA | Braulio Baptista

OFFICES | 6 (Around the World)

+ INFO



34 LITTLE

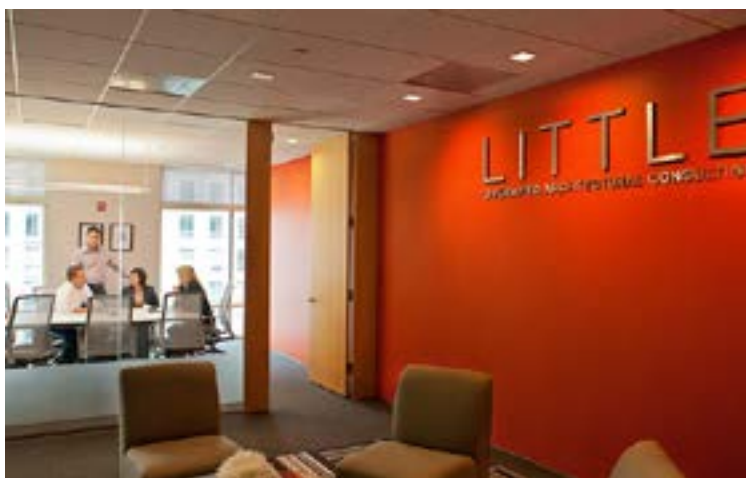

INFORMATION

WEBSITE | www.littleonline.com

BLOG | www.littlespeakeasy.com

CEO | Phil Kuttner

OFFICES | 6 (Around the World)

At Little, they are dedicated to breakthrough ideas that create a better future.

They believe that the collaboration of diverse people from many fields of design is a powerful source of breakthrough ideas.

That's why they're committed to building an increasingly diverse firm, made up of people with different areas of expertise, from different cultures and generations, with different talents, experiences and passions – because they believe that it is at those intersections where the next great ideas will emerge.

+ INFO



35 STUDIOS ARCHITECTURE

At STUDIOS, they work with their clients to create built environments that express the essence of their organizations. For each project, they seek to choreograph the human experience in a way that is simultaneously pragmatic and inspiring.

STUDIOS is as much process-driven as results-oriented: they understand that the best design comes not from a predetermined aesthetic, but reveals itself through a process of discovery.

Their practice is led by 20 principals with diverse backgrounds and is managed in a non-hierarchical way that calls for the highest level of contribution from each of their 300+ staff members.

+ INFO

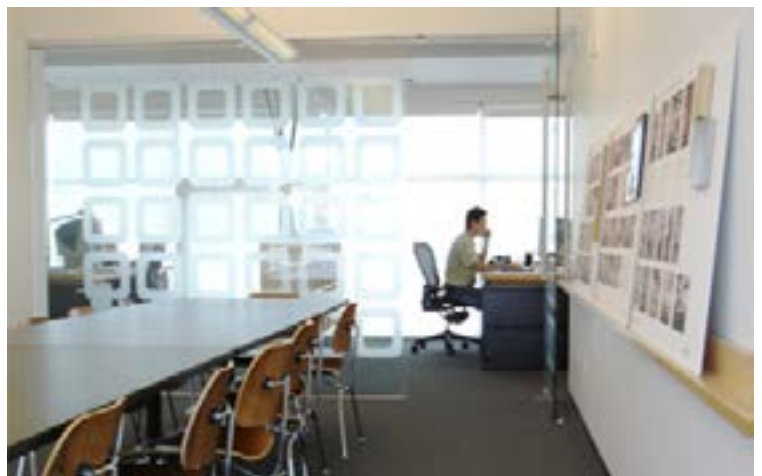

INFORMATIONS

WEBSITE | www.studios.com

NEWS | www.studios.com/news

CEO | Todd DeGarmo

OFFICES | 6 (Around the World)



36 HLW INTERNATIONAL



INFORMATIONS

WEBSITE | www.hlw.com

NEWS | www.hlwstoryboard.com

MANAGING PARTNER | Susan Boyle

OFFICES | 5 (Around the World)

Through discovery and design, they actively explore diverse ideas and cultures. Every client is different and each project expresses unique goals and aspirations.

HLW knows how to design for future innovators. In fact, they have been designing progressive technological spaces for over a century. When the industry changes, they stay ahead of the curve, creating spaces for generations to come and allowing for increased adaptability with every design.

Whether your objective is to improve the appearance and operational performance of your space or to radically rethink the way you work.

+ INFO



37 CDC DESIGNS

With more than 35 years of successfully partnering with the home builders, developers, and architects in their industry, their team offers a vast knowledge of the field. They believe in creating, sharing and inspiring in their designs and in their company culture.

Their tagline, developed as a result of an extensive branding effort in 2013, remains their corporate touchstone. This is what they stand for and what they aspire to do every day. Their work environment is enhanced by their amazingly talented staff. They believe in working hard and playing hard.

The strength of our company has always been its people.

+ INFO



INFORMATIONS

WEBSITE | www.cdcdesigns.com

BLOG | www.cdcdesigns.com/blog

PRES. OPERATIONS | Christie Pettus

OFFICES | 1

spotools

interior design publishing





38 FLAD ARCHITECTS



INFORMATIONS

WEBSITE | www.flad.com

NEWS | www.flad.com/articles/index.php

AIA | Bill Bula

OFFICES | 9 (Around the World)

Flad Architects specializes in the planning and design of innovative facilities for healthcare, higher education, and science and technology clients.

Serving clients globally, Flad is a recognized leader in resolving complex needs of knowledge-based organizations.

They work on different areas such as: Strategic and Master Planning; Programming and Planning; Site Planning and Landscape Architecture; Architectural Design; Interior Design; Structural Engineering and Industrial Planning.

+ INFO



39 ASD | SKY

Established in 1963, ASD | SKY has evolved into a multi-disciplinary design firm offering interiors, architectural, landscape, and graphic design services to a variety of corporate, financial, restaurant & hospitality, retail, medical and institutional clients.

ASD | SKY is committed to integrated and contextual design. They provide design services based on each of their client's needs and culture. They are committed to translating the needs and functional requirements of their clients into the built environment.



INFORMATIONS

WEBSITE | www.asdsky.com

BLOG | www.cdcdesigns.com/blog

PRES. OPERATIONS | Christie Pettus

OFFICES | 10 (Around the World)

+ INFO



40 RSP ARCHITECTS



INFORMATIONS

WEBSITE | www.rsparch.com

NEWS | www.rsparch.com/stories

PRESIDENT | David Norback

OFFICES | 5 (Around the World)

They are makers. Artisans. Designers. Architects. Interior designers. Planners. Experience designers. They are problem solvers. Ideators. Creators. Innovators. And with every client, every project, they seek results. Results that support client goals, initiatives and objectives.

They provide architectural design services; tenant improvement and workspace strategies; master planning; interior design; gaming layouts; facility management analytics; asset management; facility planning; and experience design.

They are headquartered in the historic former Grain Belt Brew House in Minneapolis, MN.

+ INFO



41 FRCH

If there's one thing they pride themselves on at FRCH, it's their commitment to collaboration. It's the cornerstone of their company and the driving force behind their revolutionary designs.

Through relentless collaboration comes perhaps their most coveted tool of design: inspiration. It's what stimulates their creative soul and enables them to push beyond the expected to innovation.

Hiring the industry's best designers, architects and strategic minds is certainly no accident. It is our #1 priority. Personable, approachable, honorable, professional, these are the personality traits they look for in their employees.

+ INFO



INFORMATIONS

WEBSITE | www.frch.com

BLOG | www.frch.com/us/about/news-awards.aspx

CEO | Jim Tippmann

OFFICES | 3 (Around the World)



42 MARC—MICHAELS INTERIOR DESIGN



INFORMATIONS

WEBSITE | www.marc-michaels.com

AWARDS | www.marc-michaels.com/recognitions/

FOUNDERS | Marc Thee
Michael Abbott

OFFICES | 2 (Florida)

Marc-Michaels Interior Design is set apart from other interior design firms in that they offer Interior Detailing as an optional part of your full-service design package, resulting in a seamless design/build process.

The size of their firm, magnitude of their international interior design projects, and long-standing relationships with vendors in managing the selection, purchasing, and coordinated installation of Residential, Contract, and Hospitality interiors is unmatched.

Their interior designers have a wealth of experience and knowledge gained by working all over the country as well as internationally.

+ INFO



43 VOCON

At Vocon, they're more than just designers. They're a group of people with purpose and passion. When you work with them, they listen to you. They get to know you. They solve your problems. They're not afraid to challenge you.

From their outstanding staff to their dedication to building trusting, collaborative relationships with their clients, they understand how to immerse themselves in organizations to capture clients' visions and transform objectives into reality.

From white glove customer service to a commitment to unparalleled design, Vocon has all the tools to help organizations become the best version of themselves.



INFORMATIONS

WEBSITE | www.vocon.com

NEWS | www.vocon.com/news

PRESIDENT | John C. Workley

OFFICES | 2 (United States of America)

+ INFO

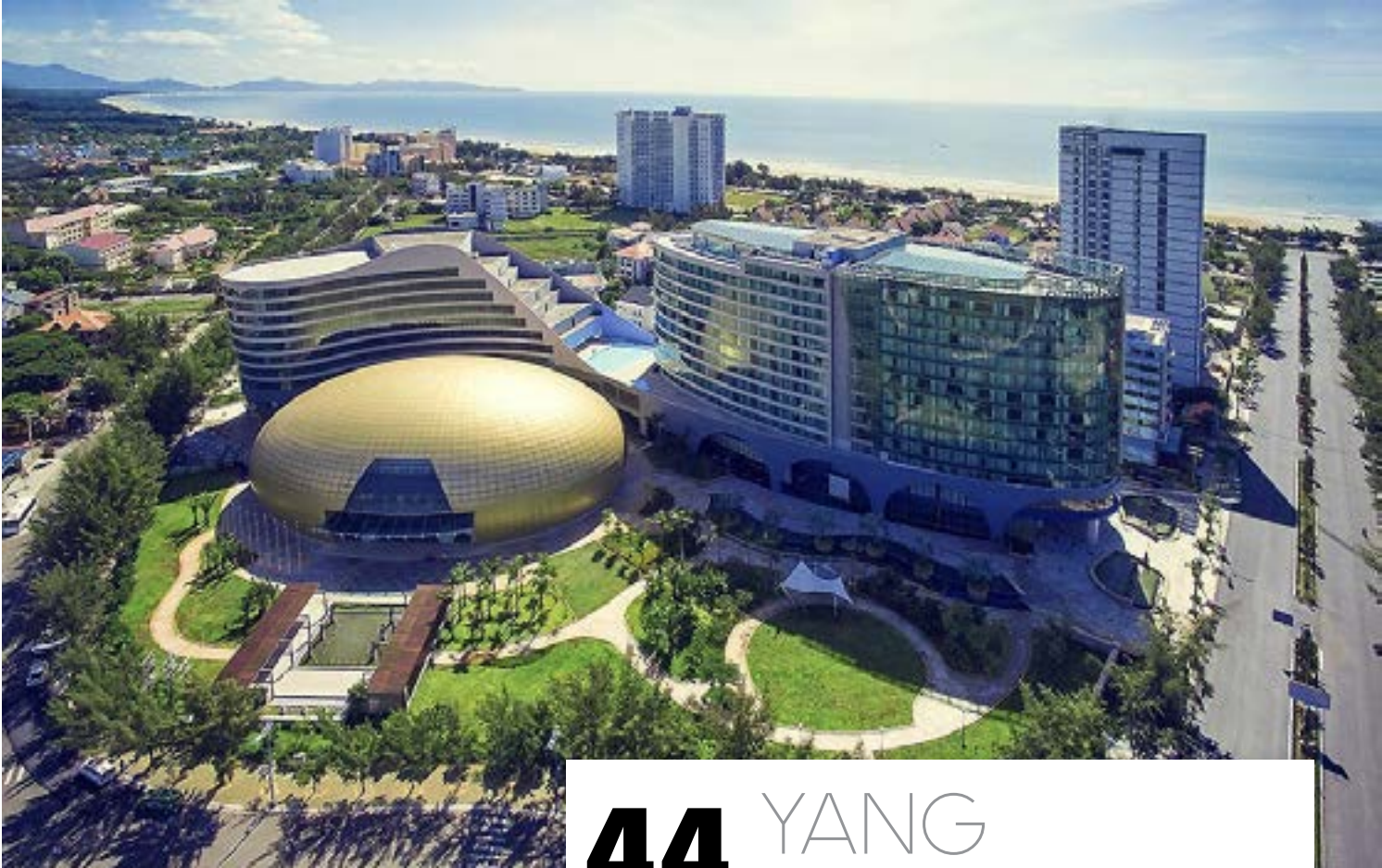

44 YANG & ASSOCIATES GROUP



INFORMATION

WEBSITE | www.yanghd.com

NEWS | www.yanghd.com/xwzx.html

BOARD | Yang Bangsheng, Huang Shengguang, Lai Guangshao and Chen Anyun

OFFICES | 5 (Around the World)

YANG has made great achievements in areas including high-end hotels design, offices design, commercial space design, real estate space design, health care and senior care space design, etc.

As the very first batch large-scale design company with Class-A Qualification, the mature organization structure and managerial system of YANG ensures the great interpretation of the unique creativeness.

Meanwhile, YANG plays a leading role in China's culturally distinctive hotel design, by insisting on an internationalized interpretation of local cultures and oriental aesthetics, and has constantly presented high-quality works.

+ INFO



45 BILKEY LLINAS DESIGN

The international hotel industry has changed dramatically over the past few years and until recently, city and resort hotels were primarily geared toward luxury relaxation. Today they are also playing a vital role in the business world.

Bilkey Llinas Design is committed to finding original solutions to these changing demands. Constantly examining new frontiers in the industry, the company's team of skilled architects and designers.

Their goal is to create hotels that not only meet the guests' functional requirements but are design experiences in themselves.

+ INFO



INFORMATIONS

WEBSITE | www.bilkeyllinas.com

NEWS | www.12.147.30.8/~bilkey/new/

PRESIDENT | Robert Bilkey

OFFICES | 2 (Around the World)



46 SAAIA



INFORMATIONS

WEBSITE | www.saaia.com

NEWS | www.saaia.com/media

BOARD | Erica Zuniga

OFFICES | 6 (Around the World)

With their extensive skills and industry experience, they are confident they can provide you professional and highly effective business-driven results.

Talented, experienced, insightful and dedicated to producing quality work.

Infused in their culture are the values of integrity, respect and commitment. These values reside within their greatest asset and key differentiator – their people.

Their ability to communicate upfront and get in front of the design challenges allows for a streamlined process without unanticipated changes.

+ INFO



47 CBT

They create authentic, engaging, high-performance design solutions where every detail matters.

Their people bring a broad range of backgrounds and talents to their team. Bound by a cooperative outlook and a passion for holistic design, they work together, bridging sectors, sharing ideas, valuing individual expression, and having fun.

Bound by collaborative energy, dynamic talent and inspired by over five decades of design innovation, CBT is a leading design firm working locally, nationally and internationally in architecture, interior design and urban design creating tomorrow's landmarks.

+ INFO



INFORMATIONS

WEBSITE | www.cbtarchitects.com

NEWS | www.cbtarchitects.com/buzz

FAIA | Richard Bertman

OFFICES | 1



48 YABU PUSHELBERG



INFORMATIONS

WEBSITE | www.yabupushelberg.com

SHOP | www.yabupushelberg.myshopify.com/

BOARD | George Yabu
Glenn Pushelberg

OFFICES | 2 (Around the World)

The Yabu Pushelberg studios redefine how the world sees and experiences the built environment. The work is designed collectively; it is imaginative, thoughtful, and honest, while continuously moving between the rational and the intuitive.

It is this interchangeability of their individual roles, that in unison, is distinctive.

George and Glenn's partnership is peerless, and their innate abilities have made them thought leaders in the design world. They are dedicated to deliver the unexpected, they constantly shift visual paradigms within every project.

+ INFO



49 EWINGCOLE

EwingCole, in practice for over 50 years, is a nationally recognized, fully integrated architecture, engineering, interior design, and planning firm of more than 350 professionals.

Their multi-disciplinary practice is built on the core values of professional excellence, design quality and collaboration. Their goal is to provide the best total solution for their clients, the community and the environment.

They believe that thoughtful design can enhance an organization's ability to achieve long-term success and improve the quality of life.



INFORMATIONS

WEBSITE | www.ewingcole.com

NEWS | www.ewingcole.com/whats-happening-ewingcole

CEO | Jared Loos

OFFICES | 6 (Around the World)

+ INFO



50 POPULOUS



INFORMATIONS

WEBSITE | www.populous.com

NEWS | www.populous.com/perspective

FOUNDER | Dannis Wellner

OFFICES | 17 (Around the World)

Populous is a global architecture and design firm that designs the places where people love to be together, like Yankee Stadium, the London Olympics, and the Super Bowl.

Populous' comprehensive services include architecture, interior design, event planning and overlay, branded environments, wayfinding and graphics, planning and urban design, landscape architecture, aviation and transport design, hotels and hospitality, and sustainable design consulting.

Populous has 17 offices on four continents with regional centers in Kansas City, London and Brisbane.

+ INFO



TOP 100 GIANTS PART 2

COMING SOON



spotools

interior design publishing



WWW.SPOTOOLS.COM